



INSTALLATION AND USER MANUAL

HYDROMASSAGE CABIN
CRISTINA

 **KERRA®**

www.kerra.pl

INSTALLATION AND USER MANUAL

HYDROMASSAGE CABIN CRISTINA

Thank you for purchasing our product. Please read this manual carefully before cabin installation. Diagrams and drawings in this manual are simplified and only contain details necessary for correct installation of the product.

NOTE: Failure to comply with instructions in this manual may constitute basis to refuse to accept any complaints.

Due to product specificity we recommend installation of the cabin by authorized installation service. Current list of authorized service points is available on our website www.novoterm.pl or at:

801 144 200

NOTE: If you decide to install the cabin yourself, we would like to advise that due to safety reasons plumbing system of the device should be installed by a qualified plumber. Plumbing system must be executed in compliance with applicable laws and regulations. Incorrect installation may cause cabin damage!

BEFORE INSTALLATION MAKE SURE THAT:

1. The place where the cabin is to be installed has been prepared as shown on the drawing (fig. 1).
2. Water connection is $\frac{1}{2}$ " and together with the valves does not stick away from the wall further than 40 mm.
3. To install the cabin you will need hoses supplying cold and hot water from the water system to the cabin. Hose parameters should be as follows: $\frac{1}{2}$ " x $\frac{1}{2}$ ", length of connection hoses should be selected according to individual needs. Connection hoses are not provided in the set.
4. The drain hole is 50mm in diameter and is adapted to standard rubber reducers available on the market. The set does not include a reducer.
5. Water parameters in the system are within the limits set out as recommended. If water parameters exceed the recommended limits, use filtering/purification device ensuring appropriate parameters.
6. The plumbing system has been flushed and equipped with angle valves with mechanical water filters.
7. Static pressure in the water supply system does not exceed 4.5 bar. **For safety reasons we recommend installation of pressure reducer regardless of the measurement results – temporary pressure fluctuations are possible even if it is not shown by a measurement.**
8. We recommend connecting the cabin to the municipal water mains, a water storage heater or heater with electronic temperature control. **Do not connect the cabin to a hydraulic instantaneous water heater. For some functions such heater may not turn on or water may not reach the temperature desired.**
9. The room where the cabin is to be installed is equipped with working and efficient ventilation system.
10. The place of cabin installation has level surface at even level with the remaining part of the room, and level vertical walls. The cabin is not intended to be built in or placed in a niche.

Compliance with the above requirements is necessary for correct installation and use of the cabin and ensuring subsequent free access.

Fig. 1

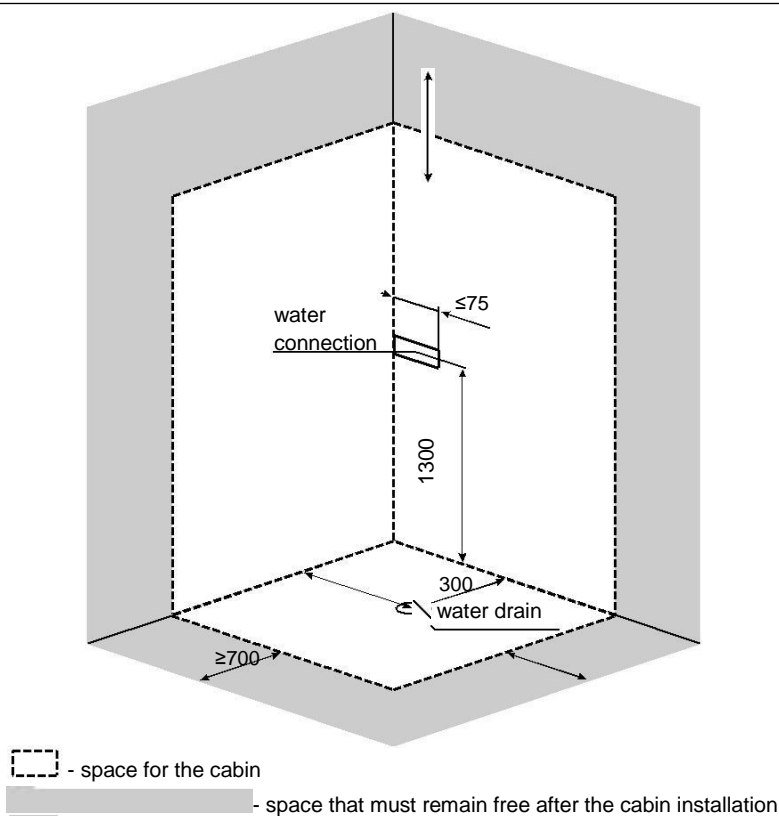

TECHNICAL PARAMETERS

Recommended hydraulic pressure: 2 - 4 bar

Recommended hot water temperature: 55 - 65°C

Recommended cold water temperature: 10 - 20°C

Recommended water hardness: $<15^{\circ}\text{n}$

Ambient temperature: 15 - 30°C

Dimensions of Cristina 80 cabin: 80 x 80 x 243 cm

Dimensions of Cristina 90 cabin: 90 x 90 x 243 cm

TOOLS REQUIRED

To make sure that cabin installation runs smoothly, please get the following tools ready:

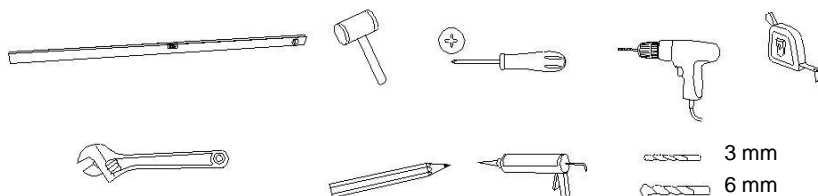

LIST OF COMPONENTS

NOTE: Check if the set is complete immediately after purchase. Any missing or damaged parts should be immediately reported to the seller.

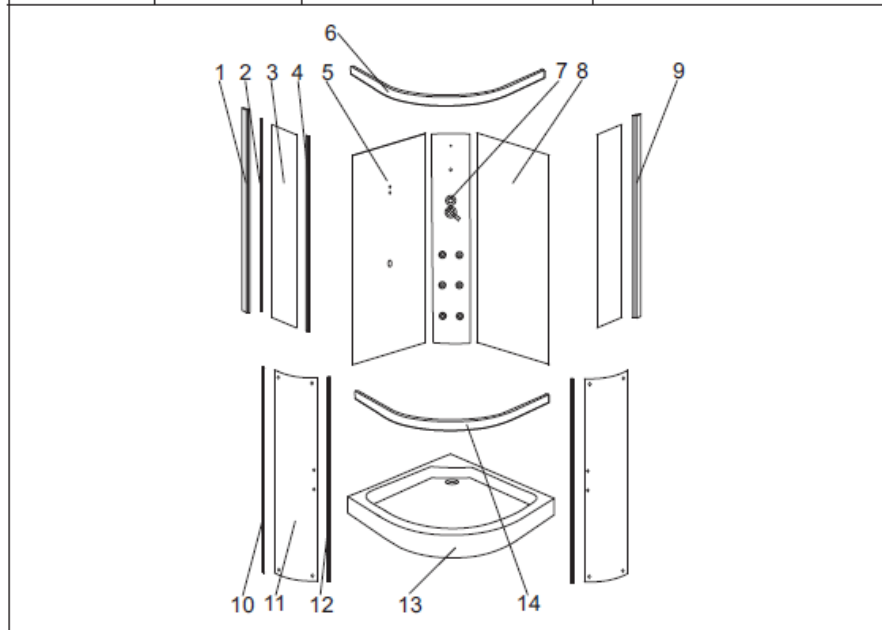
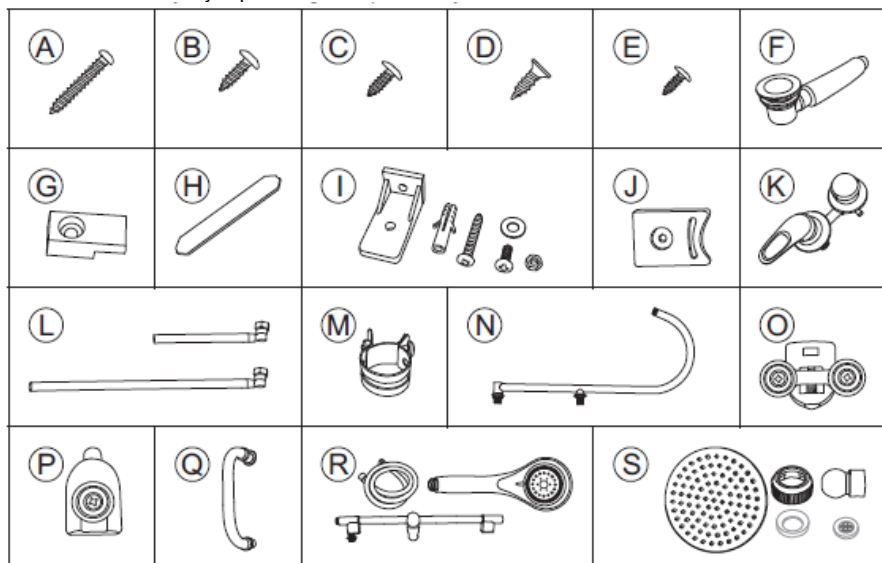

symbol	name	qty	symbol	name	qty
A	screw 4 x 25	8	1	left side profile	1
B	screw 4 x 14	6	2	“U” shape cross-section seal	2
C	saucer-head screw 4 x 12	20	3	fixed glass	2
D	countersunk head screw 4 x 12	4	4	rubber seal of side glass	2
E	screw 4 x 10	8	5	left rear wall	1
F	drainage	1	6	top horizontal profile	1
G	fixed glass handle	4	7	shower panel	1
H	shower panel cover	2	8	right rear wall	1
I	wall mounting	4	9	right side profile	1
J	buffer	8	10	door rubber seal	2
K	mixer	1	11	door glass	2
L	connecting hose - set	1	12	magnetic seal	2
M	band clip	3	13	shower tray	1
N	rain shower head arm	1	14	bottom horizontal profile	1

CONSUMABLE COMPONENTS

symbol	name	qty	symbol	name	qty
O	top roller	4	R	shower set	1
P	bottom roller	4	S	rain shower head	1
Q	door handle	2			

NOTES BEFORE INSTALLATION

Glass elements of the cabin are made of safety glass. It is necessary to be particularly careful during unpacking, handling and installation of glass parts. The glass should not be put directly on the floor or leaned against walls. Do not hit them or lever with hard tools. Damaged glass will break into tiny pieces!

Before finishing with silicone clean all surfaces of any dirt. We recommend waiting about 24 hours after the cabin installation for the silicone to bind.

Openings for the drainage in the shower tray are standard size. If necessary, you may use different drainage set than the one provided in the set.

NOTE: Check all components before installation. Do not install the cabin if you find that any of the components is damaged!

13x 1 Fx 1

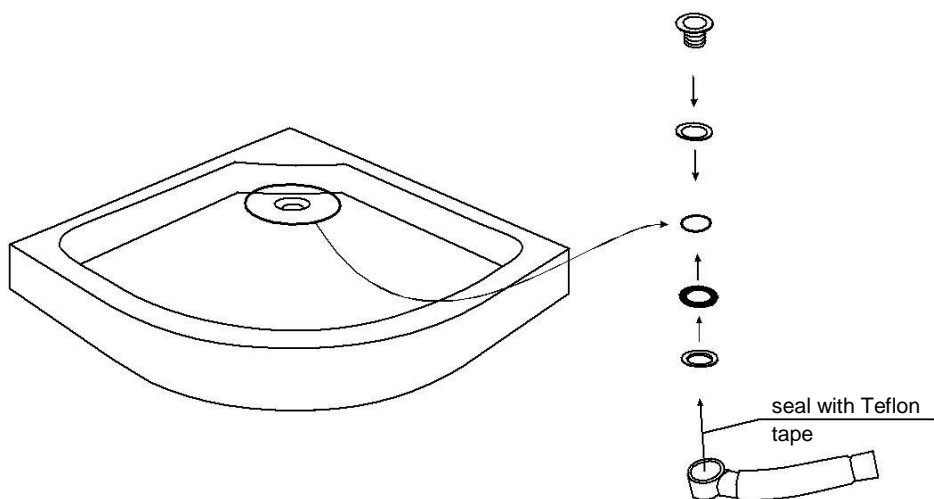

Leave a gap of minimum 2 mm between the floor and the edge of the shower tray cover!

Resting the shower tray cover edge directly on the floor may cause it to crack!

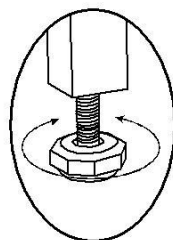
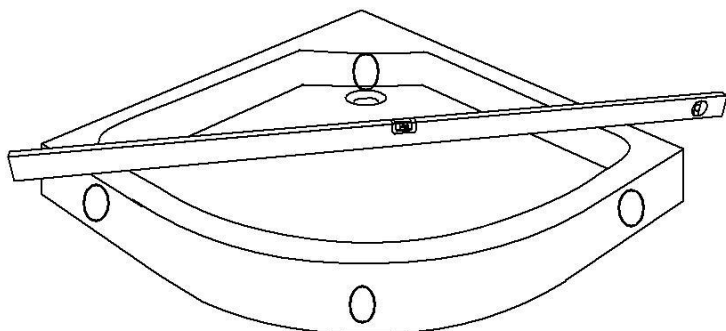

① x 1 ⑥ x 1

⑨ x 1 ⑭ x 1

Ⓐ x 8



Top and bottom horizontal profiles are different.
Buffer spacing of the top profile is smaller than
of the bottom profile.

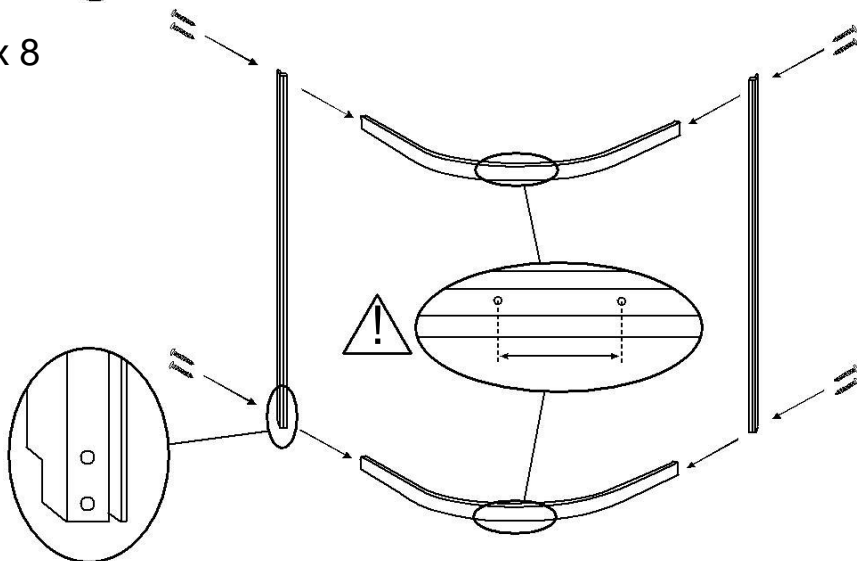

② x 2 ③ x 2

Ⓓ x 4 Ⓔ x 4

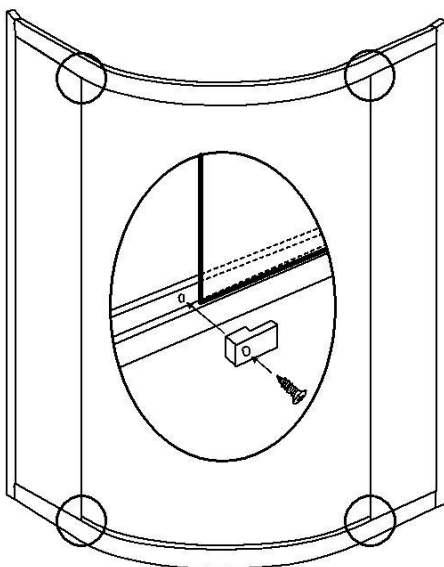
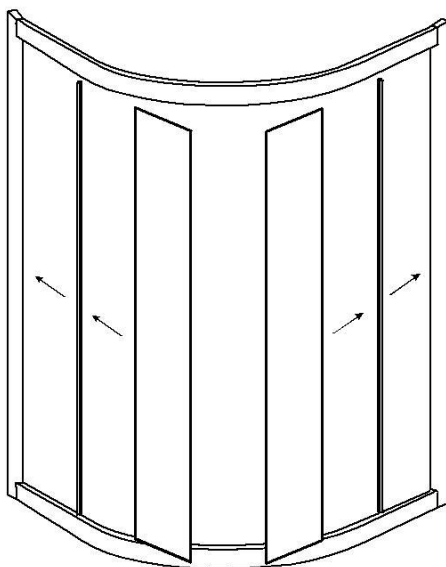

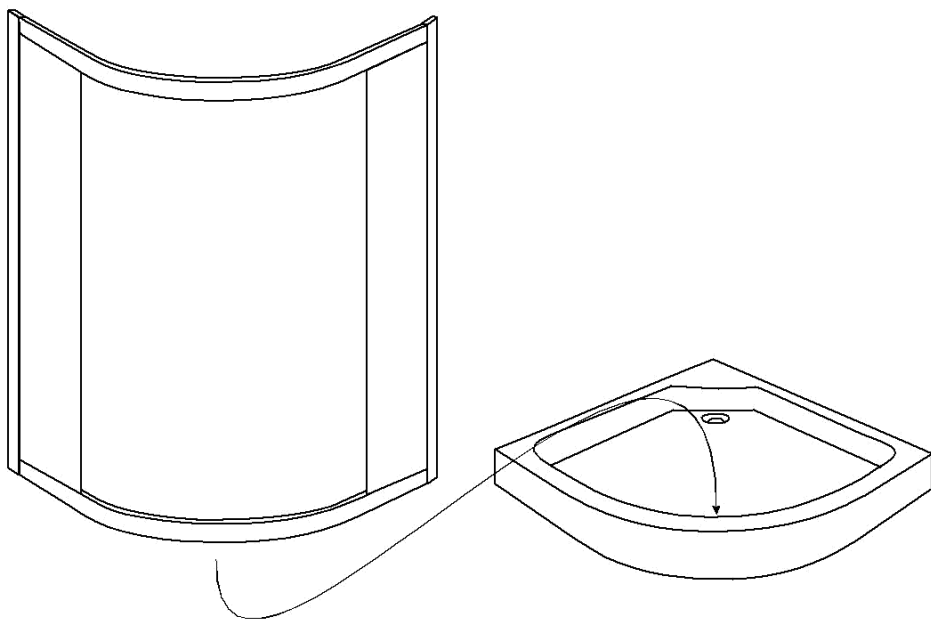

⑤ x 1 ⑧ x 1

Ⓒ x 10

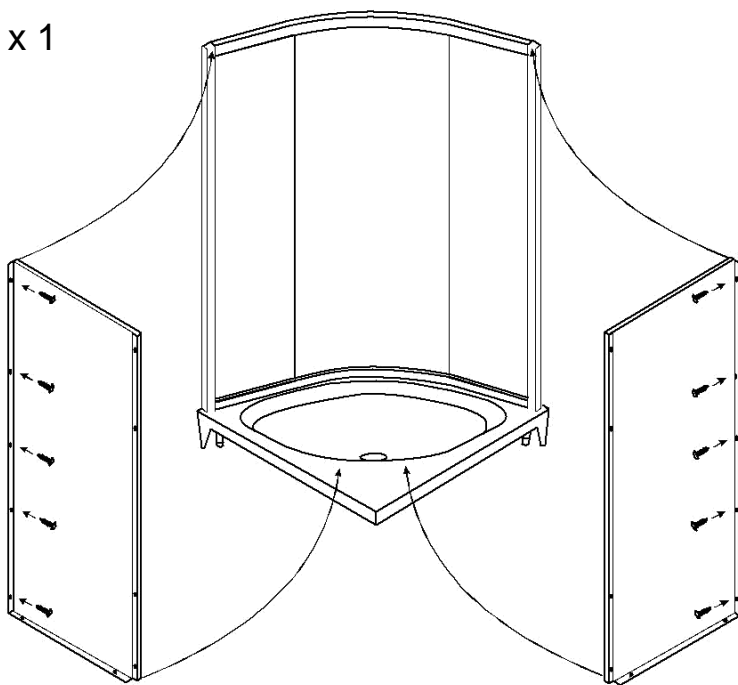

⑦ x 1

⑨ x 2

① x 1

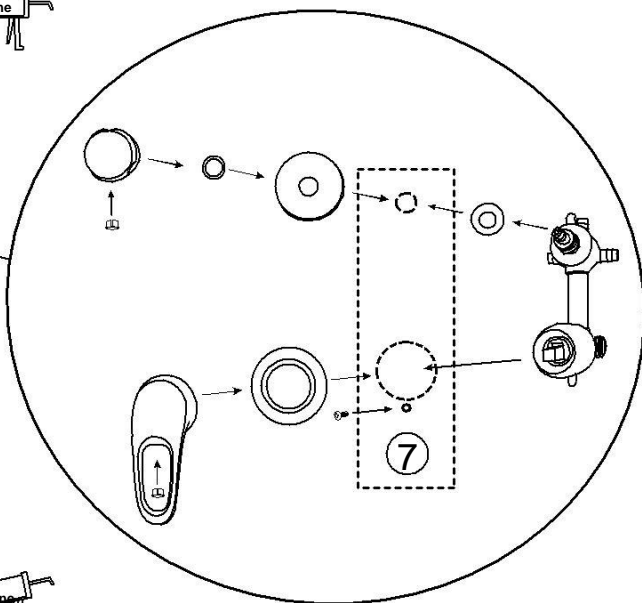
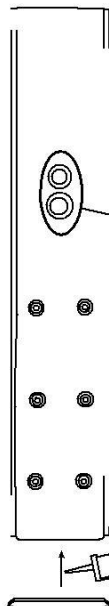
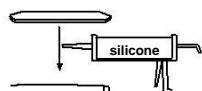

③ x 10

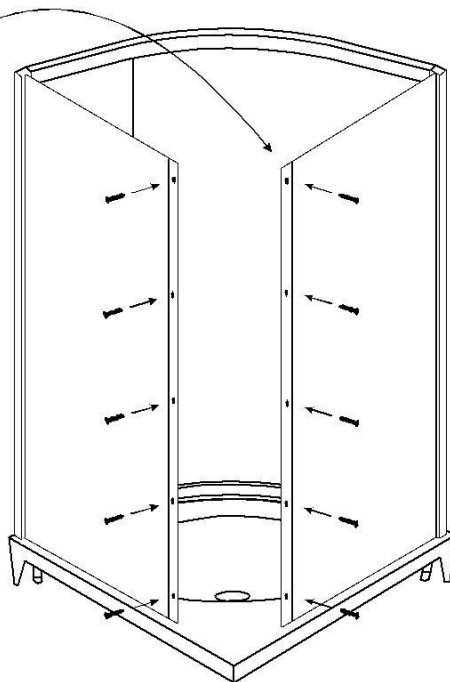
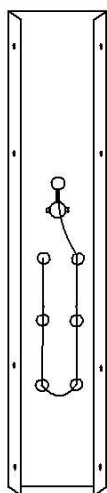

Ⓑ x 4

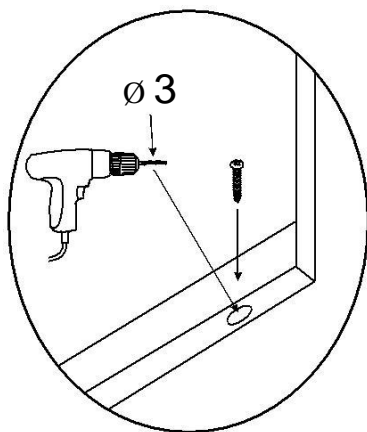
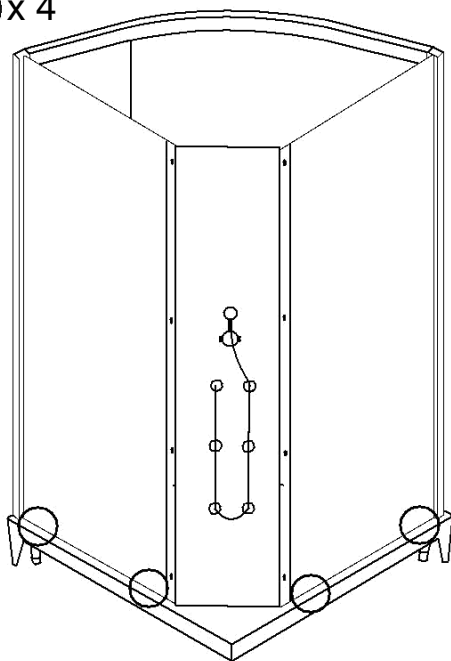

Ⓘ x 4

Keep for further
installation steps.



x 4

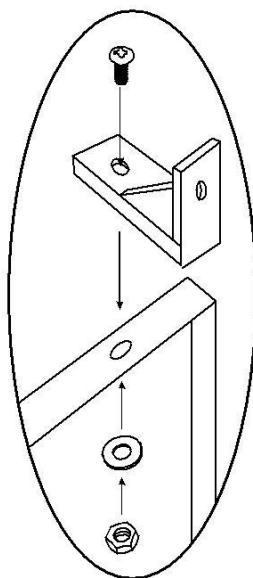
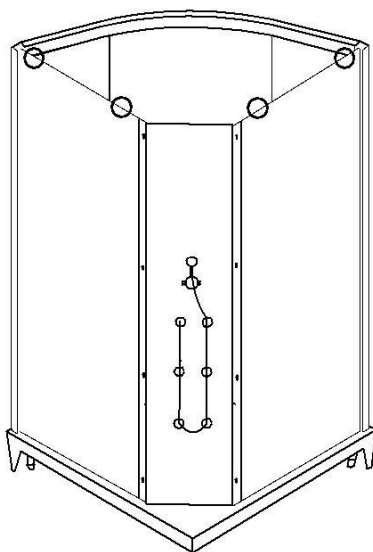

11 x 2

O x 4

P x 4

Q x 2

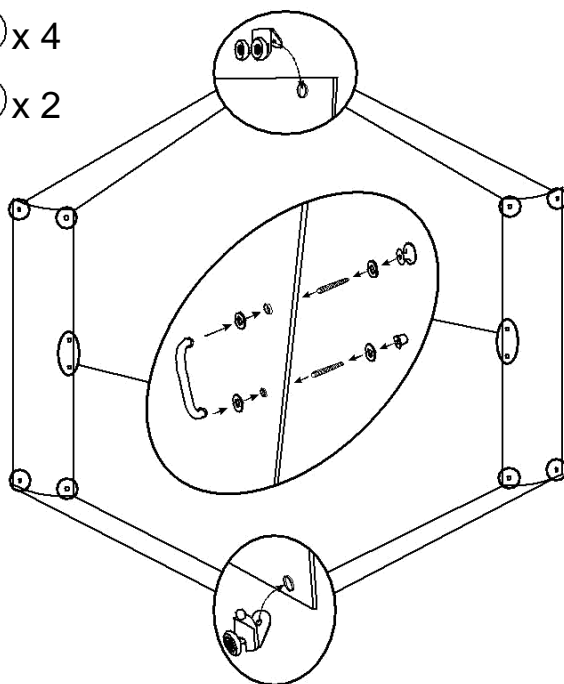

4 x 2

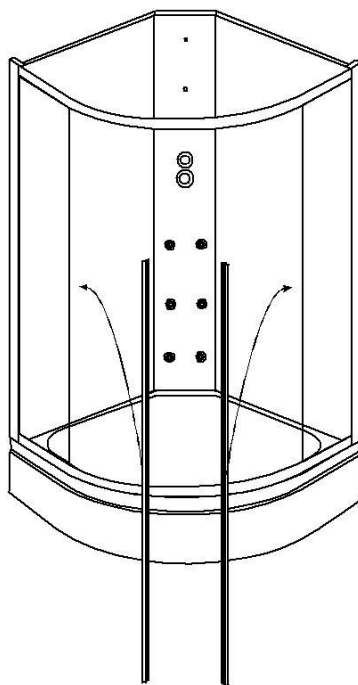

⑩x 2 12x 2

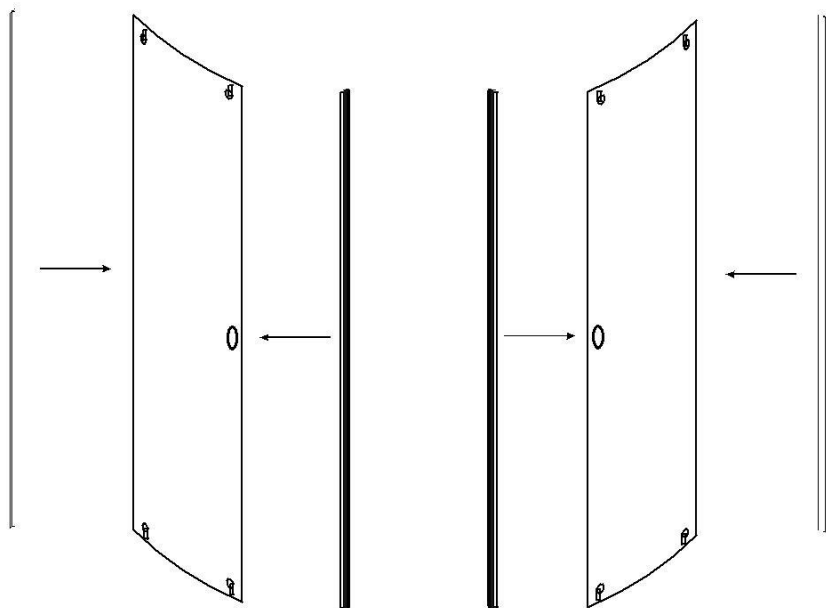

⑤x 8 ①x 8

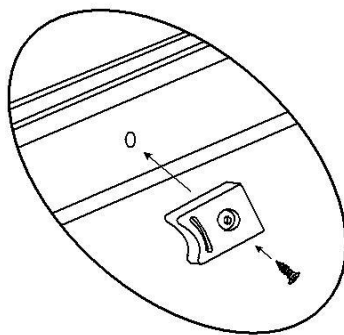
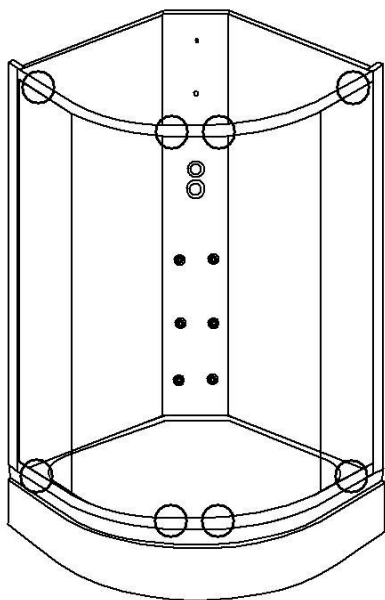

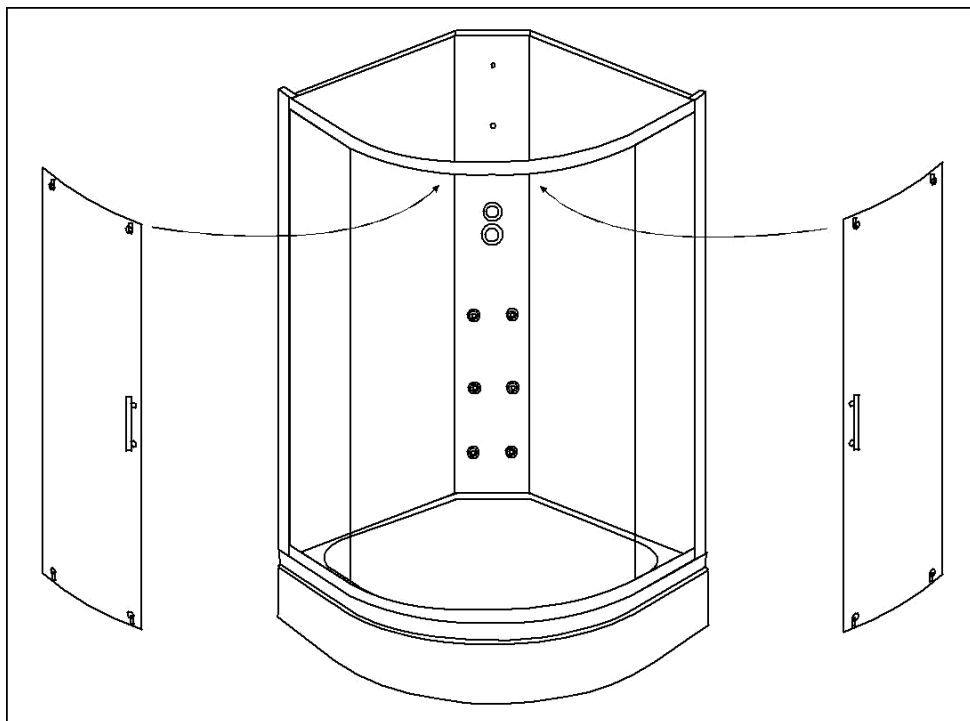

At this stage fit the magnetic seals together – if the installation was performed correctly, there should be no gap between them!

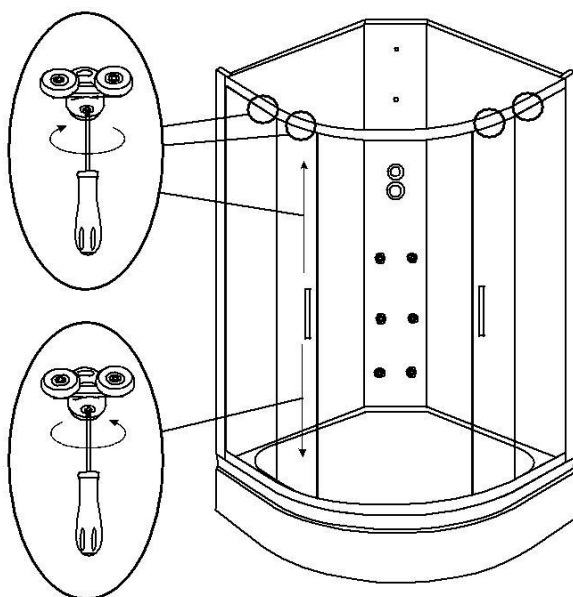

Ⓐ x 1 Ⓑ x 1

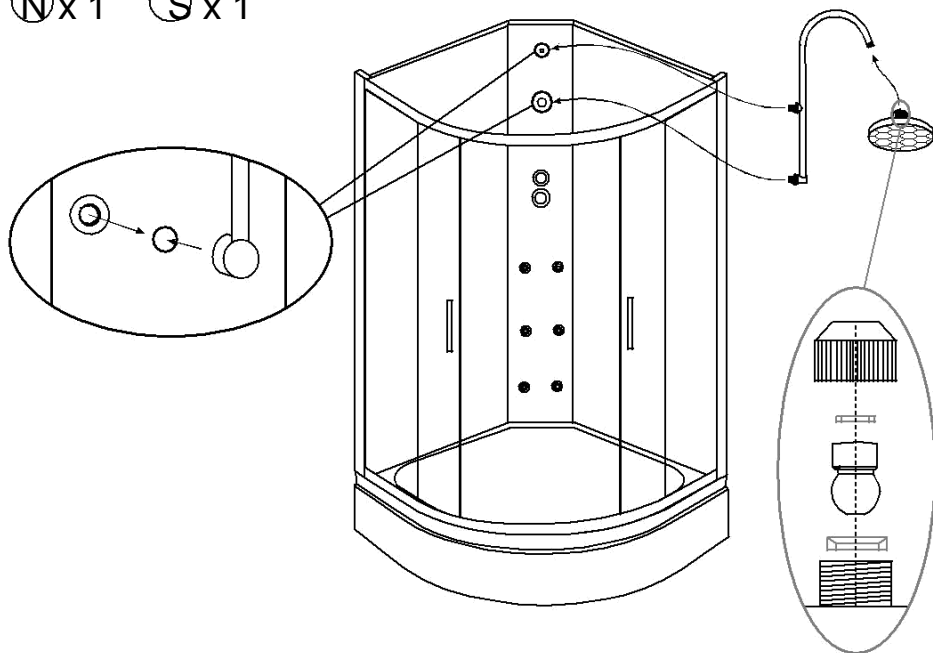

Ⓒ x 2 Ⓓ x 1

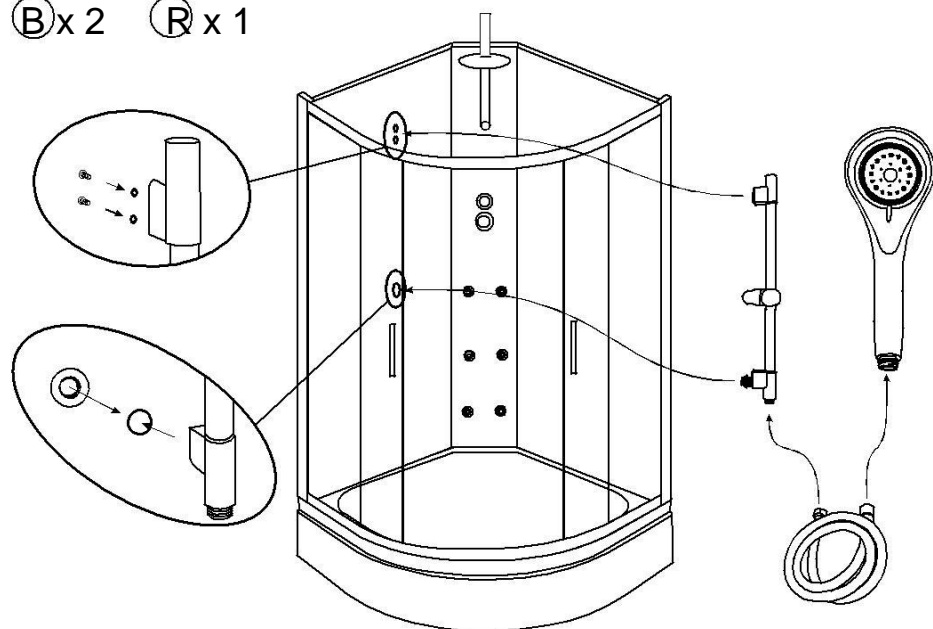

Ⓛ x1 M x3

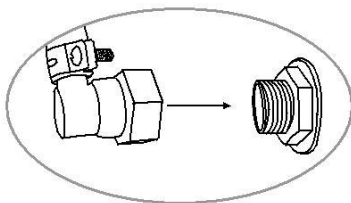
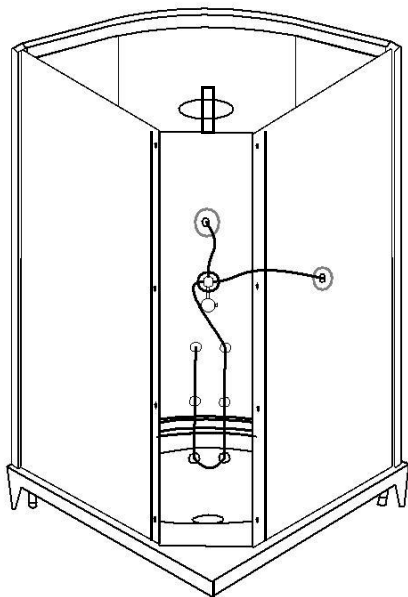
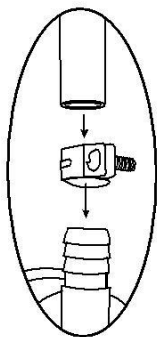

Wall plugs included in the set are not all-purpose plugs. Wall plugs should be appropriate for the wall to which the cabin is to be attached.

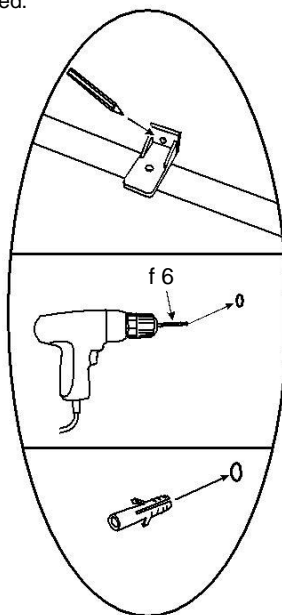
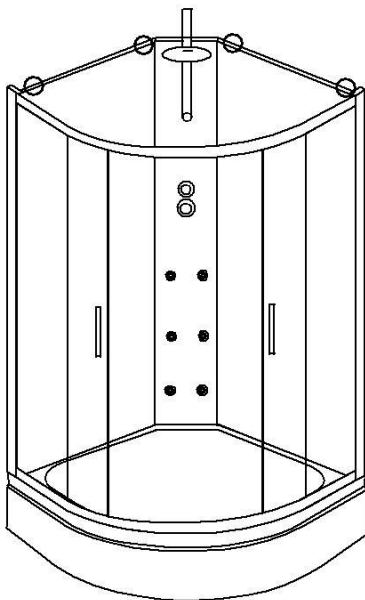

 Connecting hoses and drainage reducer are not provided in the set.

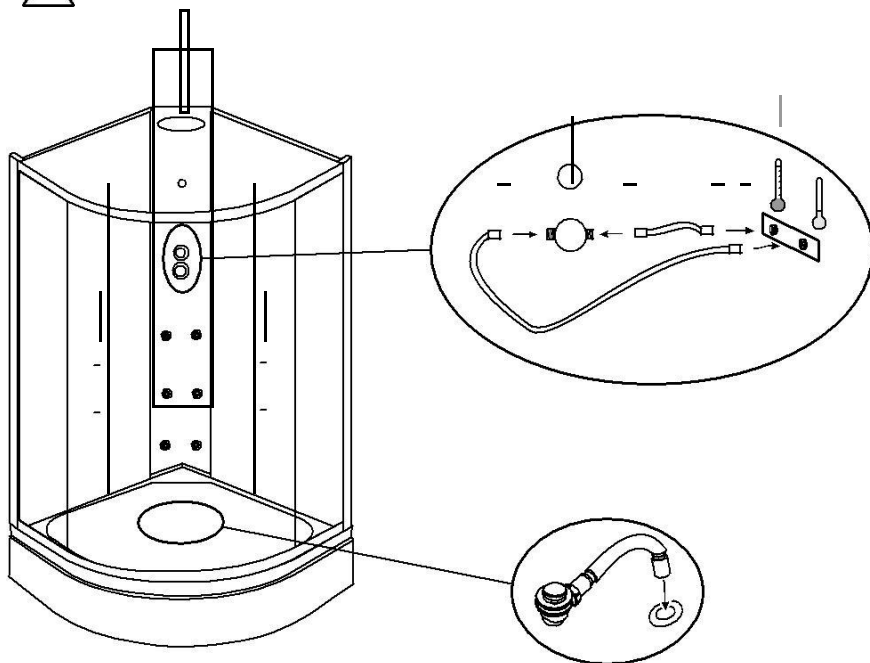

Before finishing with silicone clean all surfaces!



After the cabin is finished with silicone we recommend waiting 24 hours for the adhesive to bind! Apply silicone from the inside of the cabin.

After the silicone binds, check if the cabin is waterproof! Any leaks should be removed before it is attached to the wall!

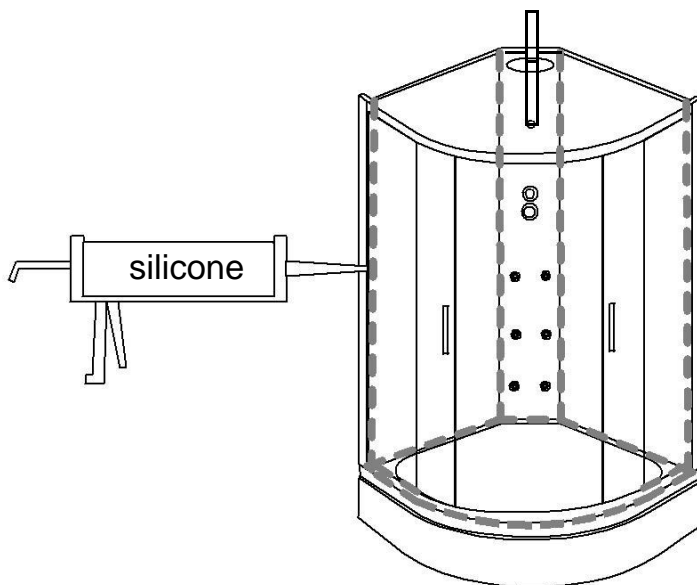

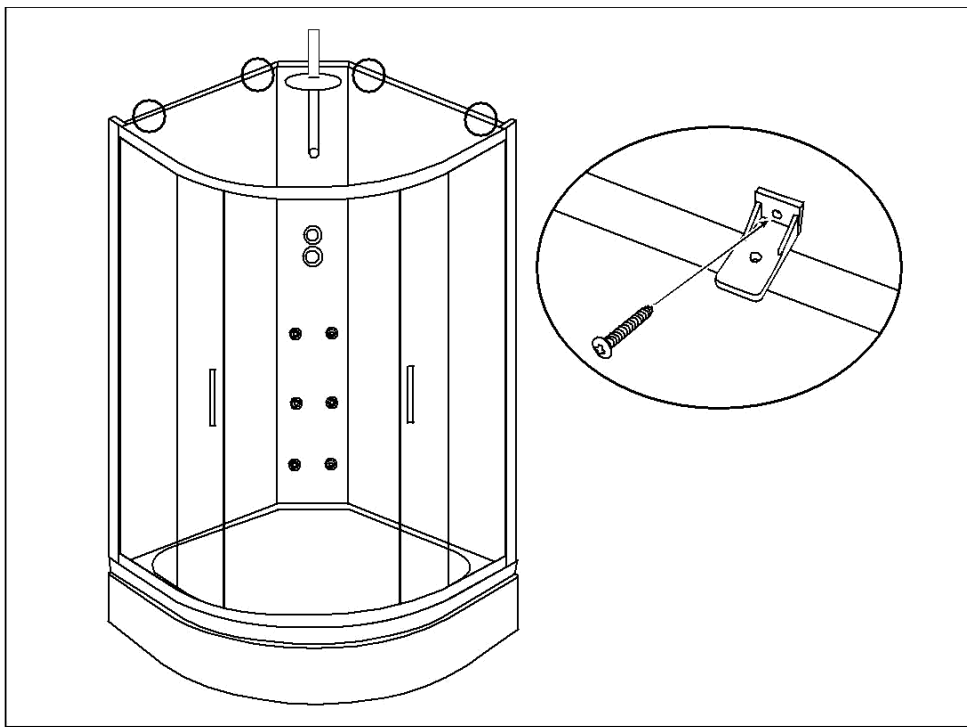

CABIN USE MANUAL

FUNCTION CONTROLLER AND MIXER

function
selection



FUNCTION
CONTROLLER

Individual functions are selected by turning the knob of the function controller to the left or right. Functions are independent of each other and cannot be used simultaneously.

water
flow control

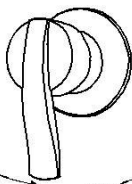

MIXER

Pulling the mixer handle up increases the water flow, pushing it down decreases the water flow. To increase the water temperature turn the handle left, to decrease it – turn it right.

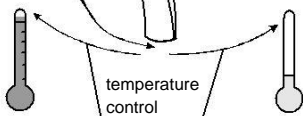

The massage function in the cabin is provided by massage jets installed on the shower panel. They use narrow directional water jets at high pressure.

The application of the massage function affects:

- muscle relaxation
- reduction of pain

SHOWER HEAD

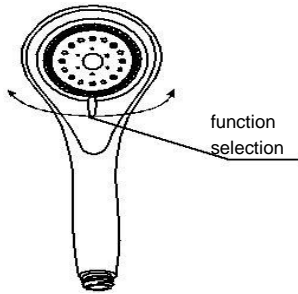

Shower head function selection is done through turning the disk to the left or right.

NOTES CONCERNING SAFETY, USE AND CHARACTERISTICS OF THE CABIN

1. For safety reasons do not use in the cabin any electrical equipment which is not an integral part of the cabin. Such devices should be out of reach of any person using the cabin.
2. Do not leave any metal objects in the cabin. They may corrode.
3. It is recommended that you consult your doctor before using hydro massage. It is particularly recommended for people taking any medication, suffering from a heart condition, diabetes and pregnant women.
4. Unless your doctor advises otherwise, do not use the hydro massage for more than 15 minutes at a time.
5. For safety reasons, children should use the cabin supervised by adults.
6. Any repairs should be performed by an authorised service.
7. The cabin is intended for household non-commercial use only.
8. Do not open or close the cabin doors abruptly. Do not lean on the glass or the panel.
9. Do not use the cabin under the influence of alcohol or drugs.
10. Do not allow the cabin to come into contact with water of the temperature over 65°C, open flame or glowing objects.
11. Even slightest contact with nail polish or hair spray is not allowed.
12. The cabin may be used only if it is fixed to the wall.
13. If the cabin is not used for prolonged periods, close water valves.
14. Do not use the cabin if it is damaged.
15. Allowed load on the shower tray bottom is 100 kg/0.5m², however, no more than 150 kg for the whole surface of the bottom of the tray. The cabin may be used only by one person at a time.
16. Even after the water supply is shut off, water may still drop out of the rain shower head, shower head or jets due to gravity.
17. Even if the cabin is level some water may remain on the bottom or the sides of the shower tray. This is a normal phenomenon caused by surface tension.
18. Tolerance of the glass dimensions: thickness: +0.3 mm; convexity: +1 mm; height/width: +3 mm.
19. Tolerance of other dimensions: for dimension ≤1000 mm - ±5 mm; for dimension >1000 mm - ±10 mm.
20. Life of consumables is 12 months.
21. Substitutes of other manufacturers are not recommended. Differences in parameters may have negative effect on the correct operation of the product.

MAINTENANCE

1. After each use rinse the cabin thoroughly with clean water and wipe with soft damp cloth - prolonged contact of the cabin surface with personal care products may cause damage to the surface or corrosion of metal elements. Leave the cabin door open until it is completely dry and ensure proper ventilation of the room. The cloth used must not contain any abrasive or scratching fibres.
2. Clean the cabin surface with the use of mild detergents and soft cloth. We recommend using solution of liquid soap. After cleaning, rinse the cabin thoroughly with clean water and dry – prolonged contact of the cabin surface with detergents may cause damage to the surface or corrosion of metal elements.



Do not use aggressive agents containing caustic, irritant or abrasive substances. They may damage the cabin surface. The cloth used must not contain any abrasive or scratching fibres.

3. To remove residue of calcium or limescale use citric acid dissolved in water 1:5. Rinse the descaled surfaces thoroughly with clean water and dry. Prolonged contact of the cabin surface with descaling agent may cause damage to the surface or corrosion of metal elements.
4. In case of small scratches on the surface of the shower tray, sand wet damaged surface with sand paper (#2000), and then polish it with polishing paste and polishing equipment.
5. Inspect the condition of the consumable parts at least once a month and apply additional silicone grease on the rollers if needed. Replace any used up elements.
6. At least once a month descale the water jets in the shower head, jets on the shower panel and rain shower head. Blockage of those elements may lead to damage or defect of elements of cabin hydraulic system. Replace any used up elements.
7. At least once a month inspect the condition of the water filter and if needed clean it or replace it. Dirty or damaged filter may cause decrease of water flow and in extreme cases also damage of the elements of the cabin hydraulic system.
8. If the product is used a lot, that is at least 30 hours per month, maintenance described in points 5-7 should be performed at least once every two weeks.

Rev. 3.1

Date issued: 04/05/2015

The logo for KERRA, featuring a stylized icon of three horizontal bars to the left of the word "KERRA" in a bold, sans-serif font, followed by a registered trademark symbol (®).

KERRA®

Producer:
NOVOTERM Sp. z o.o.
ul. Zimowa 6, 70-807 Szczecin
www.novoterm.pl